

VOLVO



Nissan Leaf driving instruction

NISSAN



Start-up (Connect 12V Battery before commencing)

(Tighten negative terminal nut with 10mm nut)

1. Firmly press brake pedal; push IGN-ON-Button. Check that warning light  is not blinking.
2. Check that Shift-Indicator on the combi-meter is in [P] position.
3. Push & hold IGN-ON-Button, and check that  has changed from blinking to constant, and then release.

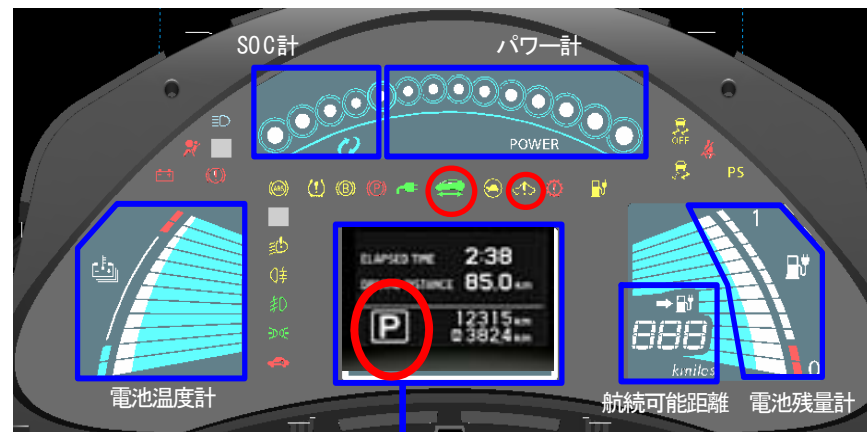

Volvo Logistics

Risk Management, Arne Lingårdsson, Fie-195

2 2011-09-01

VOLVO

NISSAN



Zero Emission

Driving operation

1. Depress the brake pedal.
2. Release the parking brake.
3. Shift the selector lever into the D (Drive) position. When going backward, shift the lever into R (Reverse) position
4. Confirm shift position by indicator located near the selector lever or Dot matrix liquid crystal display.
5. Depress the accelerator pedal and start driving.

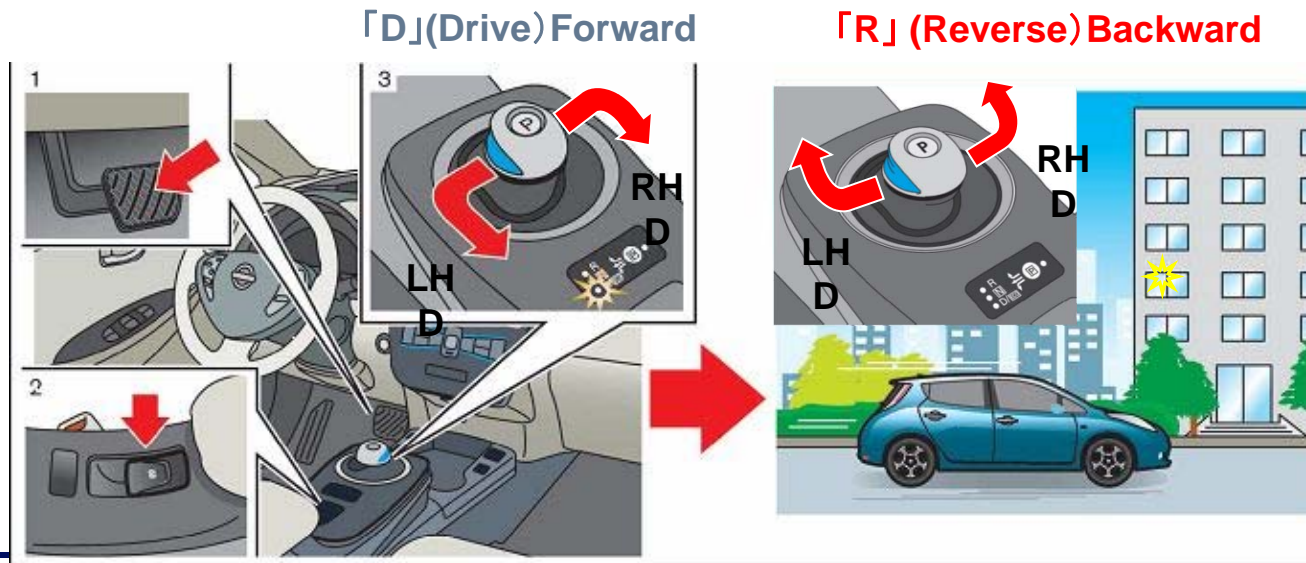

Volvo Logistics

Risk Management, Arne Lingårdsson, Fie-195

3 2011-09-01

VOLVO

NISSAN



Zero Emission

Parking vehicle

1. Press the 'P' position switch and confirm shift indicator P (Park) position.
2. Apply the parking brake as shown in illustration 2.
3. Press the power switch. The EV system turns off.
4. Disconnect 12V battery once in location using a 10mm Spanner.

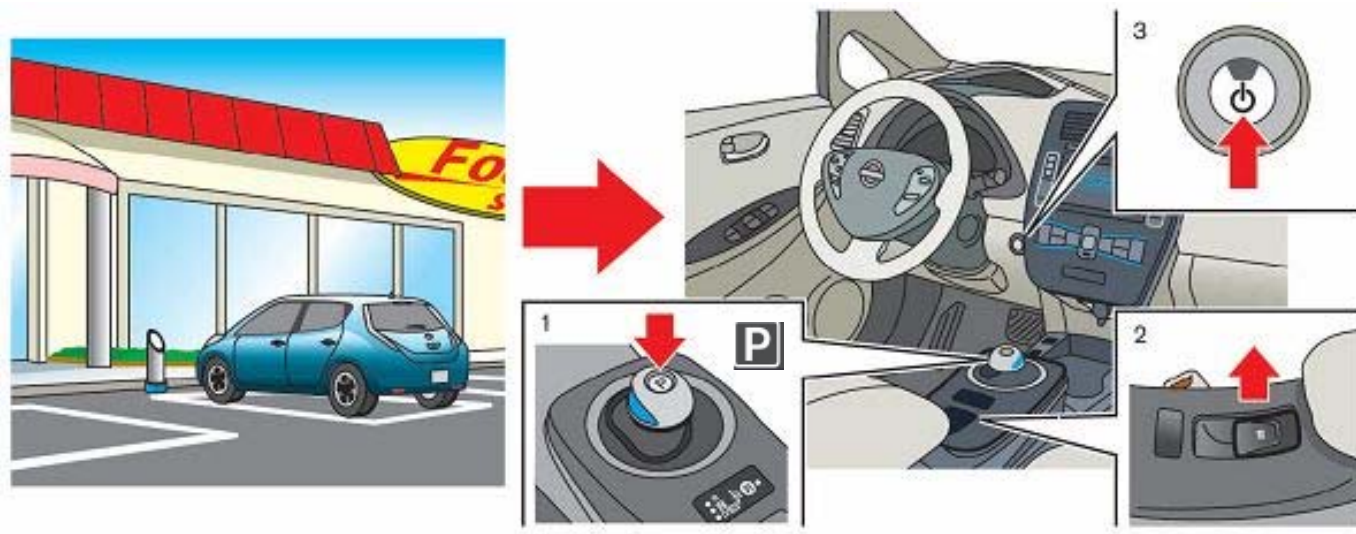

Volvo Logistics

Risk Management, Arne Lingårdsson, Fie-195

4 2011-09-01

VOLVO